

# LEXI CUBE 2522 IP67

## IP67 Flexible Linear Light for Commercial and Retail Application

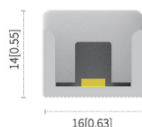

**PHILIPS**  
**LUMILEDS**

- Customized Linear IP67 Luminaire with wide beam angle for commercial and decorative lighting
- High quality IP67 Flexible LED Neon product In High Grade Aluminum Linear Body
- White/ Monocolor/ RGB /RGBW available
- Philips Lumileds LED Chip
- IP67 with UV and yellowish resistant
- salt-mist proof
- L70 B20 > 50,000hrs
- Surface Mount/ Magnet Mount/ Angle Adjustable Bracket
- Cuttable every 100mm

Technical Specification	
Lumen Output range	80lm/w
Module Power	12W/m
Operation Mode	24V Constant Voltage
Color Temperature	2700K / 3000K/ 4000K/ 6000K/ RGB/ RGBW
CRI Option	>80
Lifetime	50000 hrs
Dimension	24.5mm x 21.8mm
IP Rate	IP67/IP68*
Dimming Option	1-10V/ DALI
Operating Temp	-40°C - 65 °C

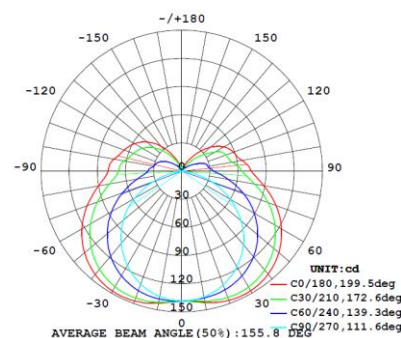
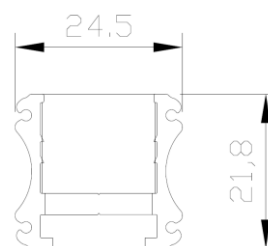

\* Special factory pre-fit required for IP68 connection

\*\*IES Files are available on request

### Installation Option

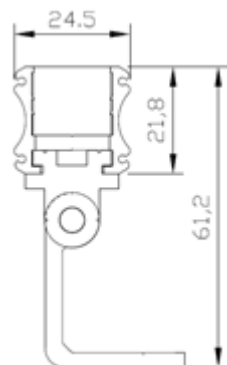

Angle Adjustable Bracket

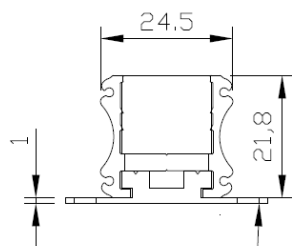

Surface Mount